

Plan of Sewerby Hall

GROUND FLOOR

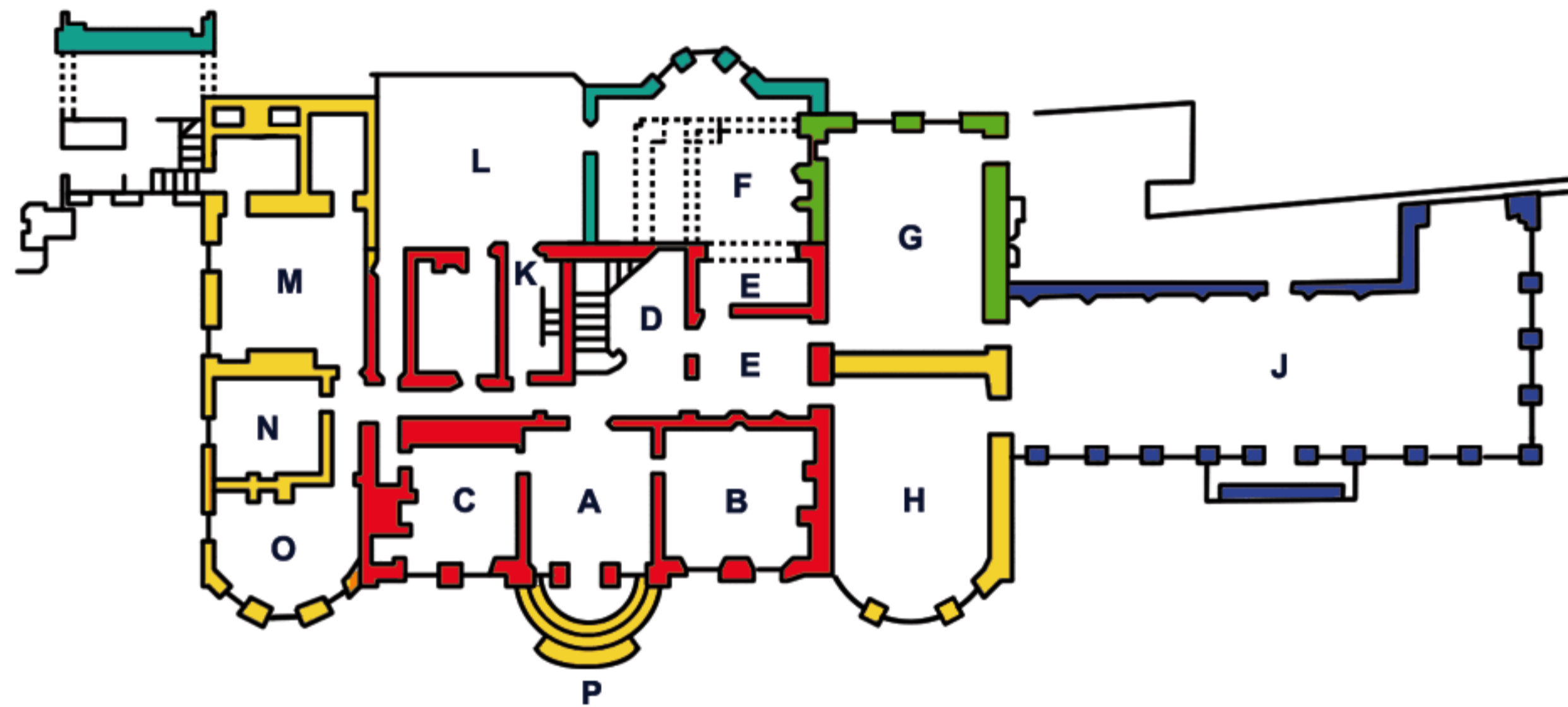

FIRST FLOOR

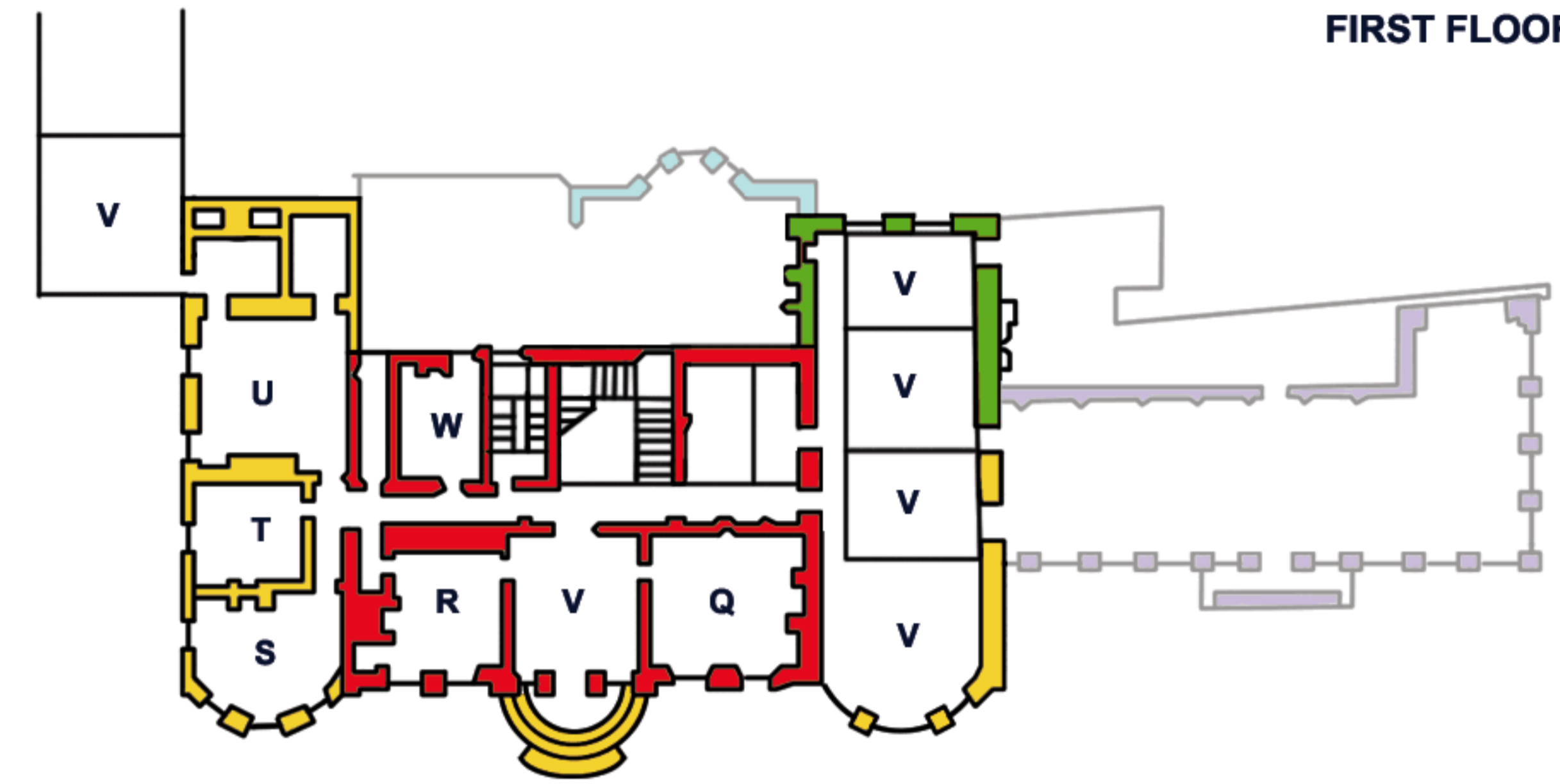

KEY

Red	c1714-1720
Yellow	1808
Green	1830
Blue	1850
Teal	1890

A. ENTRANCE HALL

Woodwork 1715, ceiling c 1808 Regency period, showing late 'Adam' influence.

B. OAK ROOM

Very fine early Georgian oak panelling, with Corinthian pilasters. Shell headed niche. Grate c 1808, chimney-piece late nineteenth century.

C. GREEN ROOM

Fine early Georgian pine panelling with Corinthian pilasters, painted almond green; chimney piece c. 1790 inserted in 1947 with grate from the old house in High Street, Bridlington. The space over the mantel originally held a "Landscaped" mirror.

D. STAIRCASE

Important 1715 staircase of oak, cantilevered construction with swept handrail and carved and twisted balusters.

E. FORMER THIRD SITTING ROOM OF 1715 HOUSE

Now part Hall, part Dining Room. The bulges in the wall are due to the niche in the Oak room and are used to support busts of marble.

F. SWINTON ROOM

Once the Library and Garden Passage constructed by Mr. Yarburgh prior to 1856, and extended soon after 1890 to form a Dining Room. Cornice details and Fireplace and doors prior to 1856. Ceiling after 1890 is a charming rococo design.

G. LIBRARY AND BILLIARD ROOM

Formally Added c 1830 as a Dining Room, but now a still room no longer containing anything of interest.

H. HALIFAX ROOM

Added c.1805 –1810, a refined and beautiful Regency Room. Original Mirrors and chimney-piece. The window to the former Conservatory is mid – nineteenth century replacement for the original glazing.

J. ORANGERY

Mid-nineteenth century.

K. BACK STAIRS c 1808

L. KITCHEN.

M. OLD KITCHEN 1808

Now an Exhibition Room.

N. OLD HOUSEKEEPERS ROOM 1808

Now an Exhibition Room.

O. OLD SERVANT'S HALL

Now an Exhibition Room.

P. PORTICO

Of stone added 1808. Doric columns showing Greek taste. Frieze in the earlier Adam manner. Curved steps probably c 1715. Doorway c1808.

Q. AMY JOHNSON ROOM

Former Blue or State Bedroom, containing some of the most beautifully detailed woodwork in the house, which with the fine blue marble mantel dates from 1715. The pine panelling which has Corinthian pilasters is painted white.

R. EXHIBITION ROOM

Former Bedroom
Lined with pine panelling of c 1715.

S. EXHIBITION ROOM

Former Upstairs Sitting Room. 1808 delicate Regency details in dado, doors and cornice. Original Fireplace.

T. HERITAGE LIBRARY COMPUTERS

Former Dressing Room 1808.

U. EXHIBITION ROOM

Former Bedroom. 1808 all original details intact.

V. EXHIBITION ROOM

W. BRIDES ROOM